

**CDC**  
**CLASSIC DESIGN CONCEPTS**  
**2015-17 Outlaw High Mount Spoiler (Coupe ONLY)**  
**CDC# 1511-7012-01**

**TEST FIT BEFORE PAINTING!!!**

**NOTE:** This product is Injection Molded TPO. We recommend taking to an Automotive Paint Facility to be painted however, it may be installed “as is”. Standard Fascia paint processes should be used, we recommend that a **FLEX AGENT** be added to the paint as well.

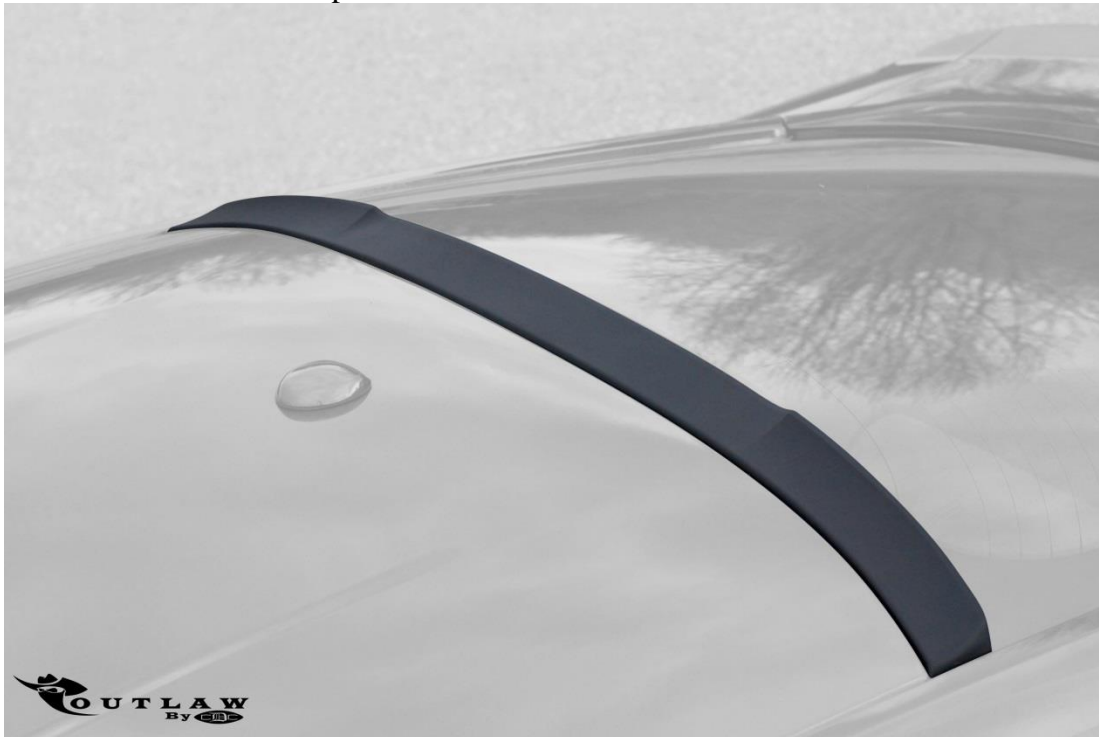

**Note: READ instructions before starting installation!!!**

**Components:**

- 1 - Outlaw High Mount Spoiler
- 1 - Alcohol Pack
- 1 –GAP-1 Adhesion Promoter Pack

**CDC Part#**

1511-2310-01  
950006  
950008

**Tools Required:**

- Glass Cleaner
- Clean Rag
- Masking Tape

**Installation Instructions**

1. Clean the rear glass with Glass Cleaner and a clean rag or paper towel.
2. Clean the glass with the supplied **Alcohol Pack**, and allow to dry.
3. Place the **High Mount Spoiler** in location and apply some masking tape as reference as shown in picture below.
4. Remove High Mount Spoiler from car and apply the supplied **GAP-1** Adhesion Promoter to glass and top of 3<sup>rd</sup> brake light.

**VERY IMPORTANT!!!** Failure to follow this step will result in improper adhesion of the **High Mount Spoiler**.

- Open packet and remove pad. Wipe on glass and covering vertically, then repeat in a horizontal direction to ensure complete coverage. Be sure pad is wetting the glass surface.
- While glass surface is wet, wipe dry with a clean, dry cloth or paper towel.
- Apply the **High Mount Spoiler** within 30 minutes.

**NOTE:** These instructions are also on the back of the **GAP-1** Promoter pack.

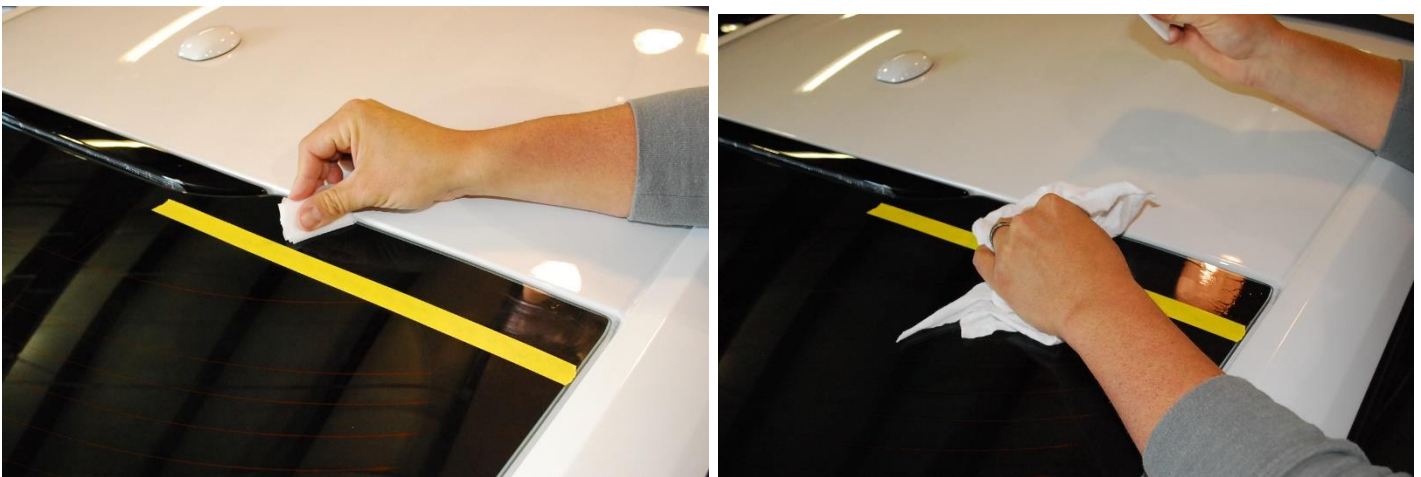

**Note:** The **High Mount Spoiler** is pre-taped as shown below.



CD4II3DL

5. Install the **High Mount Spoiler**. **HINT:** The help of a friend will make this step much easier. While one person holds one side of the High Mount Spoiler down on the glass, the other person lifts their side and removes the red backing from the tape. After the backing is removed, press into position and repeat on the other side. **Press firmly to activate adhesive of 3M Acrylic Foam Tape.**



Thank you for choosing Classic Design Concepts for your restyling needs. If you have any questions or concerns regarding installation please contact [Tech@CDCdetroit.com](mailto:Tech@CDCdetroit.com) or call 866-624-7997