



**2005 – 2010 C6 Corvette Rear Valance Kit  
CDC # 0542 - 7001 - 01**

**Note: Read installation instructions before starting**



**Kit Components:**

- Rear Valance
- Installation Instructions

**Recommended Installation Tools:**

- 1/4" Drive 10mm deep-well socket & ratchet
- 1/4" Drive 7mm Socket
- Push pin remover
- Phillips head screwdriver
- Needle nose pliers
- Safety Glasses

**Special Notes:**

- Test fit component before painting. To ensure the quality of your vehicle and the product, have your valance painted by a qualified professional automotive painting facility.
- Before beginning installation of the kit, please compare the parts you have received with the bill of materials provided, to assure that you have all the parts necessary for the installation of your rear valance.
- **CAUTION!** This component is installed around the exhaust tips. If the vehicle has been in use and the exhaust system is hot, allow vehicle to cool for at least an hour.
- In each step of removal, it is important to save all OEM fasteners, as they will be reused during assembly.
- It is advisable to wear protective gloves, clothing and eyewear when engaging in any automotive repair or product installation.
- To ensure the safety of the installer when working on or under the vehicle, be certain that the vehicle is in park, on a level surface and the parking brake is set. It may be necessary to use a wheel chock.
- Due to variations in the tolerance of production vehicles, valance may be finessed to obtain the best fit before final paint and installation.
- By using this material, the owner assumes all responsibilities and agrees neither that *Classic Design Concepts* nor any of its subsidiaries will be responsible for any and all outcomes due to the use or installation of its information and products. *Classic Design Concepts* is not responsible for damage, theft, or loss due to improper customer installation or usage.

## **Installation of Rear Valance:**

### **Preparation:**

- Raise rear of vehicle using ramp, hoist, jacks, etc., and properly support. To help ease installation, remove rear wheels. Refer to owner's manual for correct procedure.

### **Remove Stock Components:**

- While it is not necessary, installation is considerably easier when rear wheel liners are removed. In order to do so, rear wheels must be removed first. Then remove the (7) screws with a 7mm socket from liner assembly. Remove the (4) push pins using a push pin remover tool. See *figure 1*
- Remove (2) bracket bolts and washers that hold the center of the valance to the vehicle using a 10mm deep well socket. (See *figure 2*) Set bolts aside as they will be reused during installation.
- Remove (3) screws from each side of the valance using a 7mm socket. These screws hold the stock valance to the rear fascia, and are easily accessible with the rear wheel liners removed. (See *figure 2*)
- **PLEASE NOTE:** If wheel liners were not removed during the installation process, remove (4) push pins from each side of the valance that connect the wheel liver. Set screws and push pins aside as they will be reused during installation. (See *figures 3 and 4*)
- Gently pull stock valance away from vehicle while simultaneously pushing tabs down from the back side of the valance. Please note that these tabs can become brittle and break if care is not used when pulling them from fascia. There are 3 tabs along the center, and 2 on each end (one in-between the lamp mounting points, and one along the outer edge between the lamp and bolt holes. (See *figure 5 and 6*)



*Figure 1*

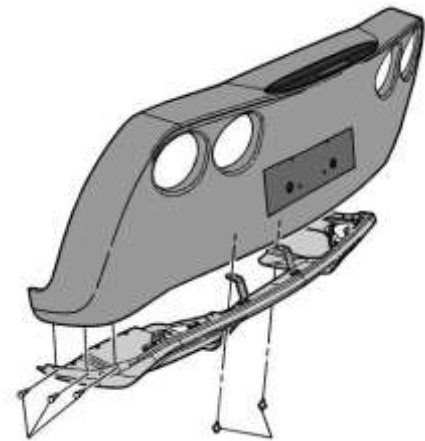

*Figure 2*

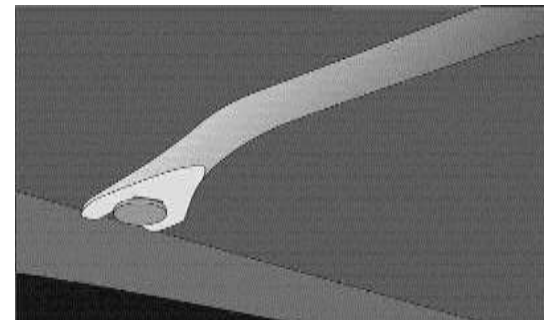

*Figure 3 use push pin tool.*

# CD4II3BV

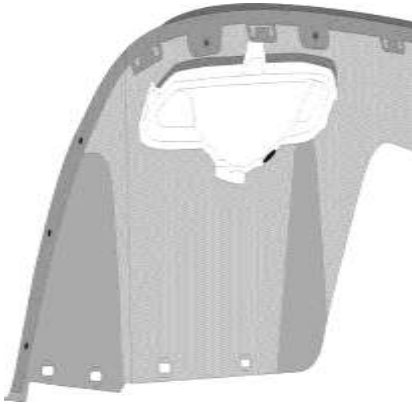

Figure 4. Push Pin hole location

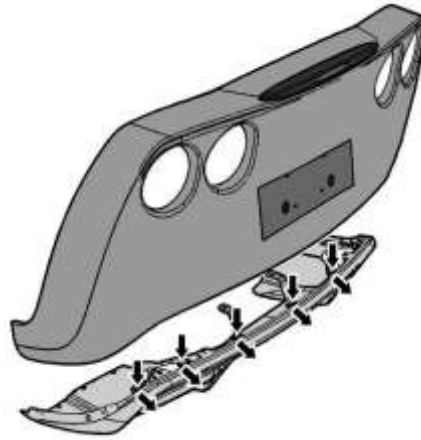

Figure 5. Five of seven tab locations

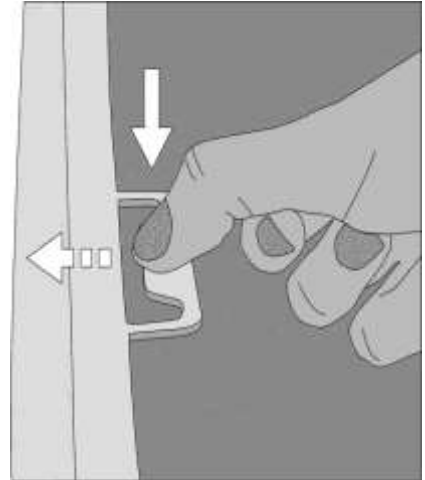

Figure 6. Tab Process

- When removing the stock valance, disconnect backup lamp harness by depressing side of connector and pulling before pulling valance away from the vehicle.

## **Disassemble Stock Valance:**

- Remove (2) screws per back up lamp using Phillips screw driver. Roll Lamp back and then lift up and away.

**NOTE:** Use caution not to break locating pins from bottom of lamp.

Set lamps and screws aside, as they will be used during reinstallation (*figure 7*).

- Remove 2 center brackets from the stock valance. Unscrew (2) Phillips head screws from each bracket. Push (4) screw grommets through tab, using care not to damage grommets, as they will be reused during installation. (See *Figure 8*.)

Figure 7. Lamp screws.

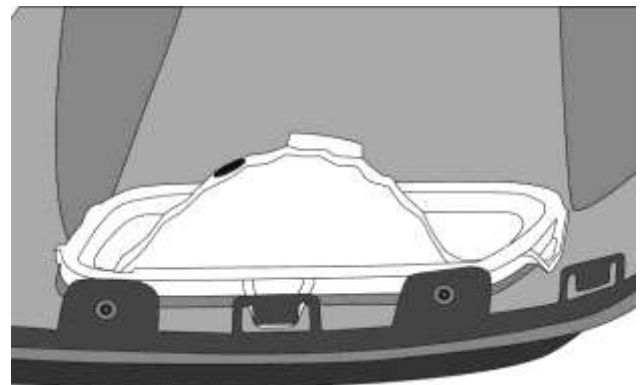

Figure 8. Center Brackets.

**Test fit Component:**

- Prior to painting, clip the rear valance to the rear fascia to verify surface and hole alignment. Due to variations in manufacturing tolerances it may be necessary to fine tune the surface of the valance.
- It is recommended that PPG products and plastic painting procedures are followed during the preparation, priming and painting. Similar products and practices may be used; however, their final performance has not been evaluated by Classic Design Concepts.
- Once the component has been painted, install backup lamps to the new valance. Lock locating pins into holes, rotate lamp forward and outboard until lamp face touches valance Center Bridge. Secure into place with two Phillips head screws removed previously. Tighten to 2 Nm (18 inch lbs.)
- Reinstall center brackets to new valance by pushing the (4) previously removed screw grommets into square holes on 2 center tabs. Then align bracket and screw together using Phillips head screws.

**Final Installation:**

- Holding valance at the back of the vehicle, make electrical connection between reverse lamps and harnesses by clipping connectors together
- Lock valance into place using upper flange on fascia and tabs on valance. Reinstall all stock hardware, tighten (3) screws on either side of the inner valance, using a 7mm socket, to 7Nm (62 inch lbs.) Reinstall (2) bolts through bracket to rear frame of vehicle, using a 10mm deep well socket.
- Reinstall wheel liners in reverse sequence of removal, ensuring that the wheel liner is installed behind your new valance. Replace (4) push pins on either side through valance to wheel liner and (7) screws using a 7mm socket.
- Reinstall wheels per owners manual

**Questions or Concerns?**

**Contact us at:**

**1-866-624-7997**

**Or**

**tech@classicdesignconcepts.com**